

The background is a vibrant red color, densely populated with various white geometric shapes. These include small dots, circles of varying sizes, vertical lines of different lengths, and parallelograms. Some shapes are arranged in clusters or patterns, while others are scattered. The overall effect is a complex, rhythmic, and abstract composition that suggests a forest or architectural structure.

**Mood  
for  
Wood**

international  
architectural  
workshop  
**2015 - 2019**

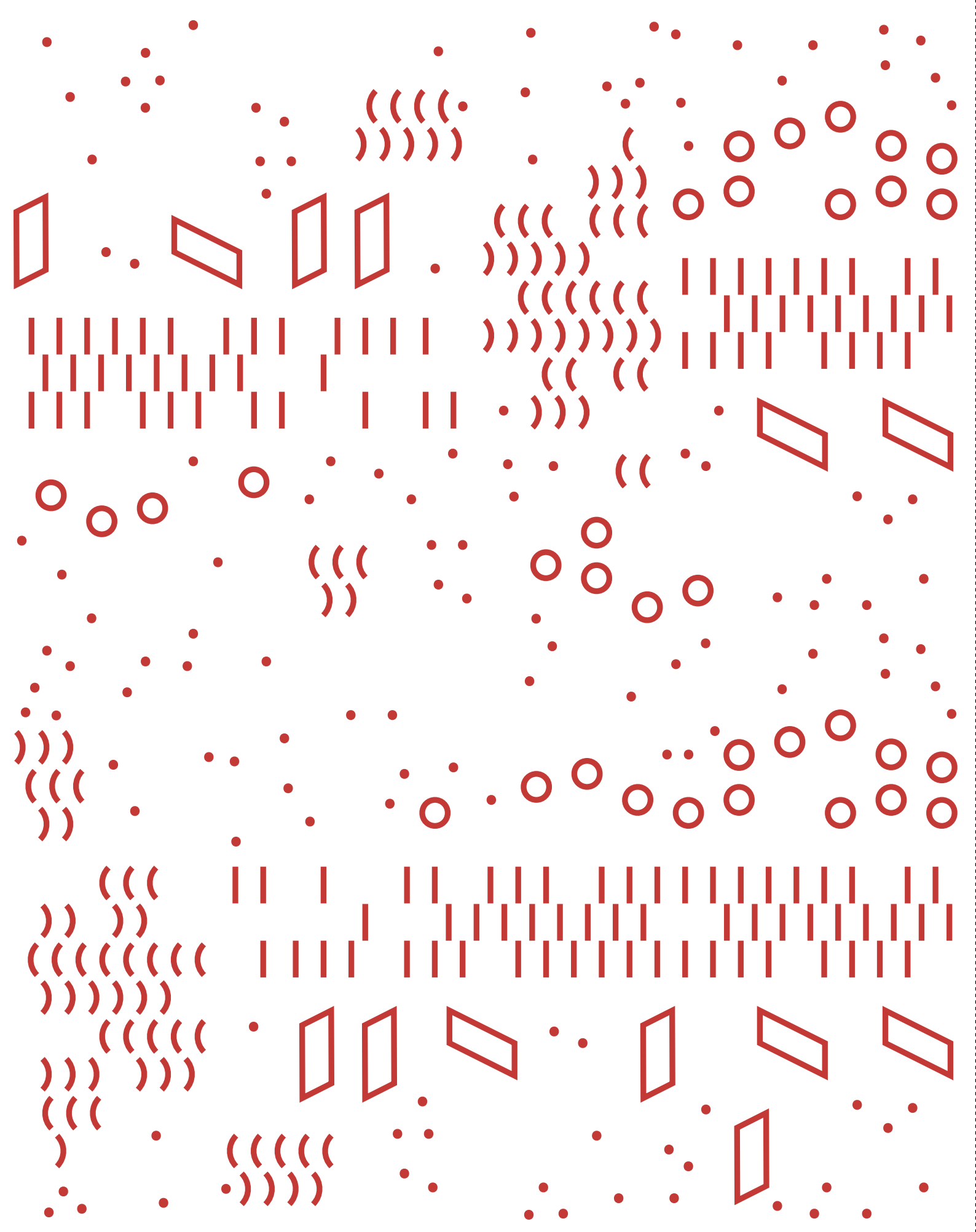

**Mood  
for  
Wood**



international  
architectural  
workshop  
**2015 - 2019**

<b>about</b>	6
<b>social gardens</b>	16
<b>courtyards</b>	22
<b>water in the city</b>	28
<b>concrete hives</b>	36
<b>common habitat</b>	<b>44</b>
<b>summary</b>	106

# observe listen think design build!



Every architectural workshop organised by Association Kolektyw 1a and Association of Polish Architects in Poznan are an adventure for their participants. The recipe for that is always to gather people from different environments and give them a chance to talk and to be creative.

Mood for Wood workshop gave that opportunity to architecture students from Poland, Czech Republic, Slovakia and Hungary - they met, they had a problem to solve and they had the right tools to build their own ideas.

During the ten exciting and intensive days of the Mood for Wood workshop, every participant was focused on teamwork, not only between the students, but also the communication with the local residents, for whom it was the first encounter with the professional designers, a first attempt to co-work in the design process.



# that's how it started



2015

In 2013, the Association of Polish Architects in Poznań organised the “Sukkot - let's build a hut” workshops during which students designed contemporary interpretations of traditional, festive huts for the Jewish holiday of Sukkot. It was the first workshop in Poland during which participants not only developed the design together, but also carried it out themselves. All constructed installations were temporary and impermanent, but for a few days they were a great attraction at the Poznań Old Market Square.

After a few days' exhibition, the question arose what would happen to the designed huts? One of them used nearly one cubic meter of wood! How to fully use the potential of student projects? Fortunately, one of the nearby restaurateurs came forward and decided to extend the life of the two constructions and use them in the restaurant's summer garden. However, the question arose whether students can create urban furniture which would serve the local community



2016

from the very beginning. Could such a design, whose recipient would be underfunded social and cultural organisations, be implemented in Poznań? This is how the idea of organising international Mood for wood workshops was born.

**The main idea was to synthesise the entire work process of a designer - to teach young designers how to design through a hands-on experience. Participants of the Mood for wood project are to undergo all stages of design work, from creating the design on paper, presenting it**



2017

**to the investor, budgeting, to making the furniture by themselves. Each element of the project is to enable analysis, learning individual needs and finding appropriate solutions for given locations and recipients.**

The choice of wood as the main material of the workshop was obvious - wood is a material with extremely diverse possibilities, extremely versatile and warm - ideal for creating friendly public spaces, even in our climate. We managed to enter into cooperation with the largest private design university in Poznań - School of Form, whose state-of-the-art carpentry workshop has become the centre of our



2018

activities and whose professional team of carpenters has been a support for us from the beginning of the project.

The last element was the selection of participants and tutors. We wanted to enable the widest possible exchange of experiences by involving young designers of various specialties from different countries. We started cooperation with several foreign universities, the Visegrad Fund and other organisations creating similar initiatives. Thanks to the exchange of ideas, we are able to increase the number of students and tutors every year, extend the time of workshops and increase the budget for each project. It has been five years since the start of the project and new, much bigger challenges await us - in which we hope you will continue to support us. See you soon!

# some numbers

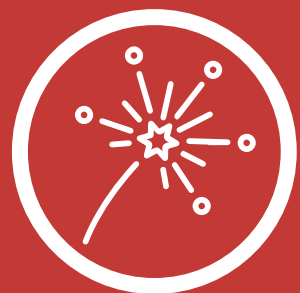

**5**  
editions  
of the  
workshop



**215**  
students



**55**  
tutors  
designers

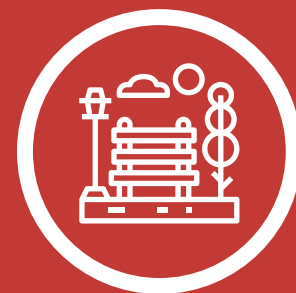

**23**  
pieces  
of street  
furniture



**50**  
publications  
per year  
in magazines  
and portals



**70**  
project  
partners



**5**  
countries  
participating  
in the  
project



**15**  
lectures  
by recognised  
designers

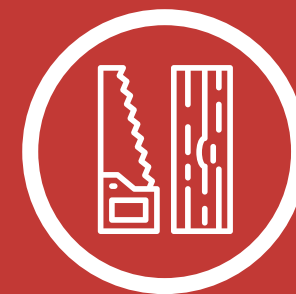

**62m<sup>3</sup>**  
of wood



**2459**  
people like us  
on facebook



**See you  
next year!**



# carpentry workshop



School of Form was established in 2011. School offers a 3.5-year full-time design course, after which students obtain a Bachelors degree from the University of Social Sciences and Humanities (SWPS). SOF is committed to the multidimensional development of the students both in terms of practical skills in general design and in understanding the nature of man, society and sensitivity to the needs of our fellow citizens through studies in the humanities. The unique study programme combines project work and an education in the humanities which has been developed by team of experts led by Lidewij Edelkoort, chairwoman of the Design Academy in Eindhoven (1999-2008), strategic director and mentor of School of Form.

In School of Form's Carpentry Workshop, Mood for Wood participants discovered the amazing properties and unlimited possibilities of wood. Under the watchful and attentive eyes of our excellent tutors - Mr. Szymon Filoda and Stefan Lazar, participants

learned how to use professional carpentry tools and work through the whole production process from a working prototype to the fine details of the final product.

The machines, equipment and tools in SoF carpentry workshop gave participants the flexibility to work with wood in a host of ways. This includes circular saws, band saws, milling machines, lathes, drill presses and sanders.





# how we do it?



## Citizens

Every design location has its users and their needs. Two on-site meetings will be arranged between participants and locals.



## Materials

The building material is of course wood. There is no limit for the amount of chosen material, except the budget.



## Budget

All design must fulfill the budget - the cost of the materials must not exceed 6000 pln (about 1500 euro)



## Design

Design work place is at School of Form, 3 days are available for group work



## Construction

Carpentry workshops are available for 5 days, the last assembly in on the site



## Schedule

Time is of the essence! Respect the schedule, be prepared for the deadlines!





# Social Gardens

# 2015

We started the first edition by searching for locations and users for whom small wooden structures can constitute an important and visible change. Community Gardens turned out to be such places - small spaces in the most neglected districts of Poznań, managed by residents and local culture-forming organisations.

The gardens attracted local community, often organising joint initiatives, but they didn't have the resources for new infrastructure. It was a real problem which workshop participants could face and solve, and for many residents it meant a real improvement in their surroundings.

**Number of participants: 40**

**Locations :**

**Kolektyw Kąpielisko Garden**

**Wilda Garden**

**Dzielnico**

**Łazarz Garden**

**Special guest: Snohetta**

**Budget per 1 group : 4000 pln**



1.



2.



**1. Location:** Kąpielisko Garden **Tutors:** BUDCUD: Mateusz Adamczyk + Agata Woźniczka  
**Student participants:** Natalija Otonicar, Barbora Tothova, Giovanna Muzzi, Bea Zsiliniszky, Paulina Frankowska, Bartosz Bisaga, Attila Cseplo, Bartosz Zabiega, Petr Vacek, Adam Mierzwa

**2. Location:** Wilda Garden **Tutors:** Hello Wood: Csaba Bányai + Áron Losonczy  
**Student participants:** Anita Farkas, Ewa Cempel, Viktor Toth, Dominik Grzyb, Alžbeta Barančíková, Marcin Derej, Stepanka Poucova, Dorota Kopania, Konrad Zaremba, Muhammed Furkan Kucuk





**3. Location:** Łazarz Garden **Tutors:** Coll Coll: Simon Prokop + Marie Davidova  
**Student participants:** Paulina Żoładak, Dorottya Bujdoso, Monika Głowacka, Filip Ponechal, Bianka Hajdu, Wojciech Kozłowski, Albret Lencses, Martyna Rajewska, Simona Tothova, Agnieszka Turczyńska, Arif Gönül

**4. Location:** Dzielnico **Tutors:** Nice architects  
**Student participants:** Tomasz Budnicki, Weronika Król, Justyna Krata, Patrycja Pokrzywa, Filip Potoczek, Zsanett Ritter, Adel laura Saghegny, Anna Smyczyńska, Patryk Ślusarski, Mehmet Ali Gasselöglu, Serkan Can Hatipoğlu

# Court yards



Mood for Wood workshops are designed to draw attention to places requiring urgent intervention and to start the revitalisation process. This is why we devoted the second edition to the area of Święty Marcin Street - which was once the most representative part of the city, but over the years its status has changed and now it is deserted, becoming mainly a car artery. However, there were still many cultural institutions in the area, for which we have created visible external elements as part of the workshops, indicating activity and attracting users.

During the workshop, students created a mobile modular stage for the Common Knowledge Society, which consisted of several dozen trapezoid wheelbarrows. Thanks to the wheelbarrows it became easier to transfer the association's materials, such as books, to an external open courtyard. For the Muza cinema, the group made a set of mobile furniture,

creating a space in which workshops and meetings could take place. The ZAMEK Culture Centre received an interactive sculpture consisting of dozens of small elements which can create both graphic forms and seats. Students designing for the University Library's courtyard created an installation of several dozen elements inviting passers-by. Quotes from workshop participants' favourite books have been hidden in the vertical forms.

# 2016



**Number of participants: 40**

**Locations :**  
**Public Library**  
**Culture Centre Castle**  
**Muza Cinema**  
**Common Knowledge Society**

**Special guest: TOPOTEK**

**Budget per 1 group : 4000 pln**





**1. Location:** Muza Cinema **Tutors:** Atelier Starzak Strebicki: Jola Starzak + Dawid Strebicki  
**Student participants:** Aleksandra Walczak, Katarzyna Maliszewska, Katarzyna Waśniowska, Matúš Peklanský, Merle Genc, Piotr Wiśniowski, Shanine Alpen, Tāňa Hronovská, Marek Svoboda

**2. Location:** Common Knowledge Society **Tutors:** Iza Rutkowska + Hugon Kowalski  
**Student participants:** Katarzyna Krefta, Lenka Levíčková, Julia Dankmer, David Zatloukal, Magdalena Priever, Patrycja Łysoniewska, Karolina Ogiolda, Lukáš Kvaššay, Ivonne Ruge



3.



4.

**3. Location:** Culture Centre Castle **Tutors:** Nils Wenk  
**Student participants:** Simon Kos, Paweł Kuczyński, Dominika Lis, Agata Ceglińska, Adam Novotník, Veronika Muzikářová, Alicja Dziedziela, Markéta Müllerová, Aleksandra Dzienniak

**4. Location:** Public Library **Tutors:** Petr Smidek + Nicole Galeova  
**Student participants:** Agata Wciślók, Aleksandra Liszewska, Anselm Hoyer, Benjamin Liberwirth, Christine Schmitz, Katarína Ambrosová, Magda Mojsiejuk, Michał Czeszejko-Sochacki

# Water in the city

# 2017



The issue of water in the city is an important matter which has been raised for years in Poznan. Despite having several reservoirs and the Warta river, many people claim that this potential remains unused. Hence, the workshop in 2016 was entitled Water in the City, drawing attention to this problem and thus starting the discussion.

For the first time in 2017, we increased the number of groups to 5, which allowed the participation of more students in the workshops. The first location - Dock in the Old Port, received a huge bench from students, which with its appearance referenced the Gothic Cathedral on the other side of the river in Ostrów Tumski. The second location was the city beach on Szelaż - students made pyramidal booths serving as protection against rain and warning cyclists about pedestrian traffic. For the ICHOT Museum on the Cybina River, the group created three giant rocking couches, while on the Rusałka Lake

a bench in the form of a winding ribbon was created. Chwiałka swimming pool - participants designing for this location decided to intervene in the grandstand built in the style of socialist realism by making a huge logo of the city of Poznań on it. Using optical illusion, students made it visible only from one particular place above the pool.

**Number of participants: 45**

#### **Locations :**

**Rusałka Lake**

**Szelaż City Beach**

**Dock in the Old Port**

**Chwiałka City Pool**

**Porta Posnania**

**Special guests: Zdenek Franek , Atelier Starzak Strebicki**

**Budget per 1 group : 5000 pln**



1.



2.



**1. Location:** Rusałka Lake **Tutors:** Studio NO - Magda Sz wajcowska + Michał Majewski  
**Student participants:** Bartosz Teodorczyk, Katarzyna Maliszewska, Elżbieta Kłeczek, Karolina Gordziewicz, Martin Mjartan, Ondrej Belica, Dániel Szabó, Dorottya Lázár, Maria Muellerova

**2. Location:** Szeląg City Beach **Tutors:** KOGAA- Tom Kozelsky  
**Student participants:** Adam Kovács, Bianka Somkutas, Jan Albert Peřina, Vaclava Kasickova, Tomas Sterančák, Nina Protušová, Piotr Pańczyk, Karolina Kulis, Aleksandra Zielonka



3.



**3. Location:** Dock in the Old Port **Tutors:** Hello Wood - László Mangliár + Nagy Máté  
**Student participants:** Artur Górski, Ala Willam, Monika Truskolawska, Mikołaj Zimny, Kristian Vnučko, Šimon Doubrava, Anette Arany, Blanka Gáspardy, Martina Urbanova

4.



**4. Location:** Porta Posnania **Tutors:** Mikołaj Smoleński  
**Student participants:** Marta Schmidt, Zsófia Berczi, Paulina Cziba, Jakub Brahmí, Marek Vilášek, Igor Jansen, Gabriela Zofia Szalanska, Martina Turanovicova



5a.



5b.

**5. Location:** Chwialka City Pool **Tutors:** 2021 architekci - Ondrej Marko + Juraj Haris  
**Student participants:** Szymon Kuś, Michał Pęczak, Viktor Toth, Olga Gumienna, Zuzia Spaltabaka, Dominika Barlová, Radka Komrsová, Klára Walterová, Anna Samszi Bakos

# Concrete Hives

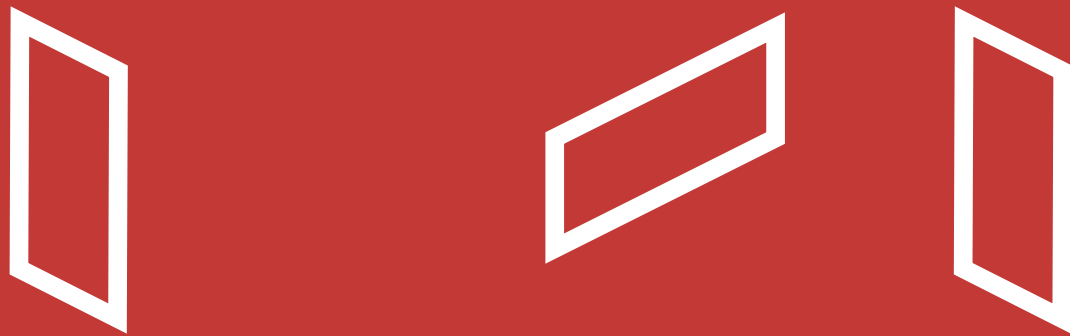

In 2018, we focused on the relics of the previous era in Eastern Europe - huge housing estates built between the '50s and '80s. Thousands of people currently live among typical large-panel constructions, but recreational spaces between buildings often remain undeveloped. Students also had to face the challenge of very specific needs of public benefit organisations.

The AMICI Foundation, organising workshops for children, received a place for outdoor exhibitions and open-air work. The bench of variable height can be used by children of all ages. For Amikus, an association of disabled people and their families, students have made a sensory playground for rehabilitation and play. While nearby a ribbon-shaped bench was created, serving additional function of a grandstand for the nearby pitch on the Orle Gniazdo estate. For senior citizens living in the Nursing Home, the group built gazebos for resting and paying chess, so that they could take

full advantage of their garden. Whereas on the POSIR sports grounds, students created a huge meadow drawing attention the entrance to the area from the river side. Each of the elements created during the workshop was designed to restore the recreational character of the spaces between the blocks and encourage spending free time outdoors.

# 2018

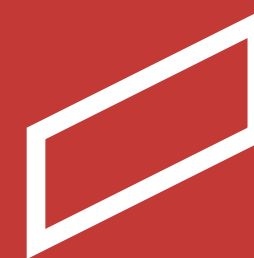

**Number of participants: 45**

## **Locations :**

**Social Assistance Home on the Piastowskie Estate  
Poznań Centres for Sport and Leisure, Rataje Division**

**“Orle Gniazdo” Community Centre**

**“Amici” Association for the Support of Children and their Families**

**“Amikus” Association for the Disabled and their Families**

**Special guests: dr Michał Wiśniewski**

**Budget per 1 group : 5000 pln**



1.



**1. Location:** Poznań Centres for Sport and Leisure, Rataje Division **Tutors:** Gaja Bieniasz + Marcin Kwietowicz  
**Student participants:** Nauras Hamdan, Natália Jušková, Zuzana Kopiláková, Maja Mawusi, Jakub Rej, Zuzia Spaltabaka, Zygmunt Śliwiński, Dóri Zachár, Vladimír Kysela

2.



**2. Location:** Social Assistance Home, Piastowskie Estate **Tutors:** Archwerk - Martin Kolda +Hana Procházková  
**Student participants:** Anna Blažková, Dominik Buchting, Filip Till, Kamil Parzychowski, Kristina Boháčová, Orsolya Vass, Robert Rössler, Weronika Kessler, Zuzana Belešová





3.

**3. Location:** Orle Gniazdo" Community Centre **Tutors:** +48 Architecture - Karol Szparkowski  
**Student participants:** Alan Kozłowski, Anton Budas, Ivana Rusnáková, Katarzyna Maliszewska, Lucie Zádřapová, Maria Katarzyna Kwiatkowska, Marek Kratochvíl, Michal Liška, Viola Bálint





4.

**4. Location:** "Amici" Association for the Support of Children and their Families **Tutors:** Studio Nomad - Bence Pasztor + Soma Pongor **Student participants:** Karolina Rossa, Kristýna Mocová, Marta Zielińska, Michał Wachura, Patrik Patil, Soňa Havlíková, Tomáš Pavlakovič, Viktoria Pálffy, Maciej Toszek

**5. Location:** "Amikus" Association for the Disabled and their Families **Tutors:** WOVEN - Anna Cséfalvay + Marianna Maczová **Student participants:** Bartosz Głowacki, Dagmar Dvořáková, Eva Linhardova, Iga Nowacka, Igor Jansen, Jakub Kender, Krisztina Németh, Mária Tomková, Weronika Kozak



5.



# Common Habitat

2019 edition of the Mood for Wood workshop was held under the “Common Habitat” slogan - the main theme was nature and the urban ecosystem. Over the past few years, the understanding of the importance of the natural environment for the quality of life is growing. Everyday struggles with air pollution, increasing temperatures

and the lack of sufficient greenery cause the wildlife in the city to become the last oasis within the urban dimension. That is why this year’s furniture and installations were created not only for recreation and ecological education, but also to support the local ecosystem, because the city where we live is not only our home - **it is a common habitat!**

# 2019

**Number of participants: 45**

**Locations :**

**Rusałka Lake- birdwatching spot**

**Rusałka Lake- dog playground**

**Dendrological Garden**

**Radojewo Park**

**Rataje Newts ecological site**

**Special guests: RAW Abajo Garcia - Begona de Abajo Castrillo**

**Budget per 1 group : 6000 pln**





# Bird watching spot at Rusaka Lake

52°25'49.5"N 16°52'08.0"E

**Tutor:** +48 Architecture - Karol Szparkowski

**Participants:** Igor Jansen, Jan Krise, Ola Darwaj, Klára Kubičková, Natalia Wiśniewska, Krystýnka Brovdij, Júlia Hegymegi, Krisztián Vnučko, Tymon Wolender

**Support:** Agata Holdenmajer, Kamila Melka

**Function:** the construction promotes ornithological knowledge among passers-by

**Users:** Rusaka Lake users, amateur bird watchers



## +48 architecture Karol Szparkowski

A young generation architect, together with Kamil Miklaszewski they opened the +48 architectonic studio. The studio is interested both in constructional as well as innovative application of materials. Karol is a lecturer at the University of Ecology and Management where he applies a workshop method, specialising in teaching object shaping through workshops. He pays particular attention to construction, erecting temporary pavilions in his classes. His method is based on illustrating and explaining the conditions which impact the building's shape. During classes with students, he eagerly reaches for the workshop method. Methodology of these workshops, which can be adjusted to diverse groups of participants, was also used while working with children from Ukraine and Georgia.

When it comes to social activity, together with other members of the +48 Group, he actively supports social organisation directly interested in architecture, city planning and historic buildings conservation, as well as those working within the field of development and education with the use of architecture and architectural workshops.



### 1. What was the biggest challenge in designing for your location?

The biggest challenge in our location was to create an object that gives an interesting opportunity to observe birds. Students proposed a lying position of observer which is comfortable to watch the birds, but difficult to obtain in the form of an object.

### 2. Do you think that these type of workshops (design and construction) bring new value to the educational system for architecture students in your country?

Of course, yes, at these workshops, students go through the full process of design and. They can see what are the consequences of decisions made at each stage of the project and implementation. This approach is not found at universities, especially in Poland.



### Student participants:

Igor Jansen  
Jan Krise  
Ola Darwaj  
Klára Kubičková  
Natalia Wiśniewska  
Krystýnka Brovdij  
Júlia Hegymegi  
Krisztián Vnučko  
Tymon Wolender

### Support:

Agata Holdenmajer  
Kamila Melka



**Location**

first visit at the location, measuring and view analyses

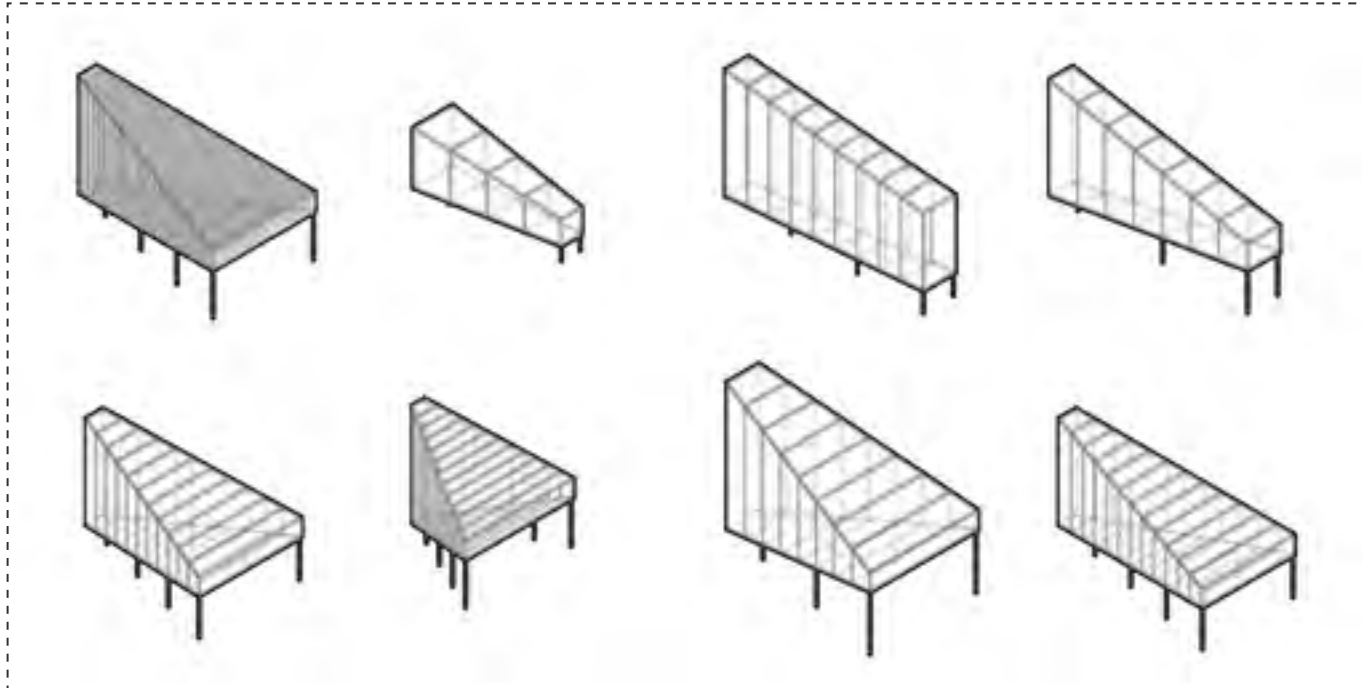

**Designing**

construction options



**Designing**

brainstorming, sketching and model making





**Project**  
model and realisation comparison



Thanks to numerous conversations with ornithologist and analysis of the characteristics of the place, a design of the object was created in a form of which forces users to observe in a lying position, and directs their eyes to the water and rushes inhabited by many species of birds. The entrance to the structure was designed so that people could enter through them individually, and the transparent facade discouraged the use of this place for, for example, drinking alcohol. The outer walls of the observatory were tanned

on one side to simultaneously impregnate the wood and create an interesting two-colored facade effect.

The final effect can be seen even from the other side of the lake, because the structure is over three and a half meters high. At the entrance to the structure there is information about bird species that can be observed on Lake Rusałka and a brief description of the project.





**Constructing**  
working at the location site





**1. What was the biggest challenge for you during the workshop?**

To come up with a great idea and concept among eight other foreign people in a group. Also to be able to build it only in three days. It was intense and challenging experience but I do not regret any moment of that process.

**2. Did your stay in Poland acquaint you with our culture, construction methods and style of architectural design?**

As a designer I can't say that much about construction methods. I like the way how every group came up with a different approach towards each tasks in the project.

**3. Did you learn something new during the workshop, that you will find useful in your studies or future career?**

I learnt a lots of things. Besides technical abilities (how to use tools etc.), it was very inspiring and challenging to manage and communicate with people that I just met few days ago but surprisingly it all worked out well and I enjoyed time working and learning about others in the group. It was truly inspiring! I want to say thank You. For me, it was the most enriching experience so far and I'm glad that I could be a part of Mood for wood workshop. And I'm definitely going to apply next year!

**Jan Kriese, Czech Republic**







# Dog playground at Rusaka Lake

52°25'57.5"N 16°52'37.0"E

**Tutor:** 2021 architekti - Juraj Hariš + Filip Ponechal

**Participants:** Kamil Parzychowski, Bernard Ambroziewicz, Natalia Serafin, Agnieszka Cieszanowska, Zöldi Sára, Marek Kratochvíl, Markéta Nováková, Matus Kurdel, Zuzana Lisonova

**Support:** Aleksandra Kamusińska + Marta Jaworska

**Function:** functionality is everywhere – just waiting to be discovered

**Users:** dogs, dogs owners



# 2021 architekci: Juraj Haris + Filip Ponechal

The 2021 architekci office has been established in 2012 in Bratislava by Peter Lényi, Ondrej Marko, and Marian Lucký. The office focuses mainly on executing public buildings, and designs in the public space which have a wider social character. The ambition of the office is to shape the way forward in terms of our perception of architecture and everyday environments. Our architects seek this in two ways: participating in contests declared by public investors and organising contests themselves.

Apart from design work in strongly differentiated scales, the architects willingly participate in workshops and self-build urban actions. Their shelves at the office feature, apart from organizers full of design documents and architecture literature, also drills, polishing machines, and containers full of bolts.



## 1. What was the biggest challenge in designing for your location?

Keep feeling of area like it was, try to reduce all of the informations what we have to solve for 10 days and try to focus on most important things on site - dogs humans interaction.

## 2. Do you think that these type of workshops (design and construction) bring new value to the educational system for architecture students in your country?

Certainly yes, because in our country we still feel that parents raise their kids so that they never get hurt, they will not have to work with tools, etc



## Student participants:

Kamil Parzychowski  
Bernard Ambroziewicz  
Natalia Serafin  
Agnieszka Cieszanowska  
Zöldi Sára  
Marek Kratochvíl  
Markéta Nováková  
Matus Kurdel  
Zuzana Lisonova

## Support:

Aleksandra Kamusińska  
Marta Jaworska



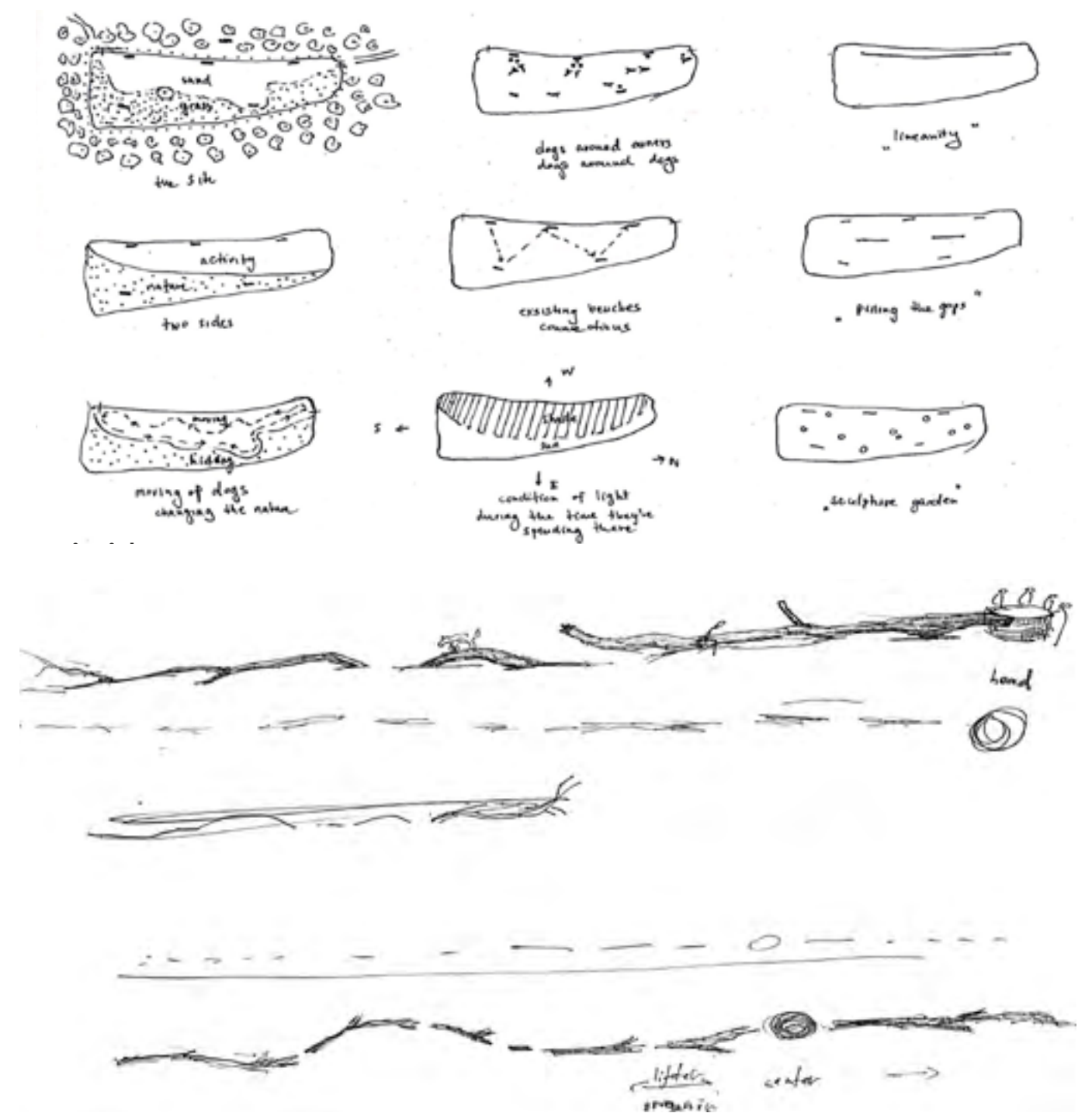

**Designing**  
sketches and analyses





**Project**  
model and realisation comparison



The group wanted to maintain current natural character and atmosphere of the place. They made a decision at the beginning of design process about using just natural wood and focus on trying to create some obstacles for dogs and some functional parts to the owners. The design for playground comes from nature, group analyzed the site deeply and grabbed its most characteristic pieces like the curvy shapes of the sand and the grass. The material was logs of wood and tree trunks which the group got for free

from the land owner. The design takes the advantage of the wide variety of chosen materials and tries to find the best combination of different size of trunks and logs. Project has linear composition and there are many type of connections of elements. Students let the users of the place to discover functionality of the installation, they for sure will find a lot of sitting or laying places, obstacles for the dogs, and table as well. The concept placed the nature exactly to the first place and let it to lead our hand to intervent.





**Constructing**  
working at the location site





**1. What was the biggest challenge for you during the workshop?**

The biggest challenge for me was that I got into the group with the task to design the dog playground and I actually don't like dogs very much so first I was not very excited to design something I am not keen on. However during the first days while intensive designing with my group I suddenly noticed that I don't care about my dislike to dogs anymore and that I just try to do my best, the best design I can make. I was really surprised and very delighted to realize this fact because in my future job I am already sure I won't design always only the things I agree with/I like. It's possible I will meet some clients with opposite point of view or taste but my task is to find a way to them and do the best I can.

**2. Did your stay in Poland acquaint you with our culture, construction methods and style of architectural design?**

I was talking with Polish people and I also made some Polish friends, I realized we are veeeeery similar. And I love it! :) I felt our slavic spirit!

**3. Did you learn something new during the workshop, that you will find useful in your studies or future career?**

Of course! Oh my god! So many things!!! :) I learned a lot of woodworking, using the machines, knowing the material better which is very important for my field of study (design) but also the way of thinking about our task, those brainstormings, analysing, finding arguments, talking about it with each other, being really concentrated and excited.

I love that this workshop is great for everybody - for the participants (they learn something, find new friends, enjoy quite cheap holidays), for organisers (they give opportunities to participants to learn something and improve the public space in Poznań) and people from Poznań (they get new public furniture for free). Just win-win for everybody!

**Marketa Novakova, Czech Republic**







# Dendrological Garden

52°25'37.1"N 16°53'44.8"E

**Tutor:** Jan Ankiersztajn + Aleksander Nowak

**Participants:** Dana Nemcová, Volodymyr Vojevodin, Kos Šimon, Viktória Pálffy, Maciej Toszek, Alicja Kowalczyk, Julita Banaszak, Anna Kolarska, Dominik Litwin

**Support:** Paweł Grabowski, Ewa Jastrząb, Patrycja Lobert

**Function:** additional space for gathering of students and visitors

**Users:** University of Life Sciences in Poznań, families with kids



## Jan Ankiersztajn

Jan Ankiersztajn is an object designer based in Poland. His practice includes industrial design, architecture and interior design. Aside from his profession he is devoted to sound design and musical composition. His ongoing research speculates about the future of design in the context of acoustics. He graduated from the Design Academy Eindhoven in the master department Contextual Design. He is a co-founder of the interdisciplinary Extra Studio; currently a PhD student of University of Arts in Poznań. He gained professional experience at Electrolux in Stockholm in Sweden and at the design office ZIETA Prozesdesign in Wrocław in Poland, among others.



## Aleksander Nowak

Aleksander Nowak is a researcher, architect and urbanist based in Copenhagen. He has a particular interest in urban and strategic planning for alternative socio-political futures and emergency architecture. His recent research work spans across various fields such as mapping, data visualisation and spatio-political changes within the Danish Welfare state, circular economy in architectural industry and post-war reconstruction strategies in the MENA region. He has is also a practicing architect who previously worked in offices such as Snøhetta and Henning Larsen Architects. Additionally, he has experience in installation art which best represents the SkyLense pavilion for the Chart Art Fair in Copenhagen and currently developed proposals for Oslo Architecture Triennale and Biennale in Shenzhen. His greatest pursuit is to discover ways in which architecture could be used again as a tool for societal well-being rather than economic speculation



### Student participants:

Dana Nemcová  
Volodymyr Vojevodin  
Šimon Kos  
Viktória Pálffy  
Maciej Toszek  
Alicja Kowalczyk  
Julita Banaszak  
Anna Kolarska  
Dominik Litwin

### Support:

Paweł Grabowski  
Ewa Jastrząb  
Patrycja Lobert



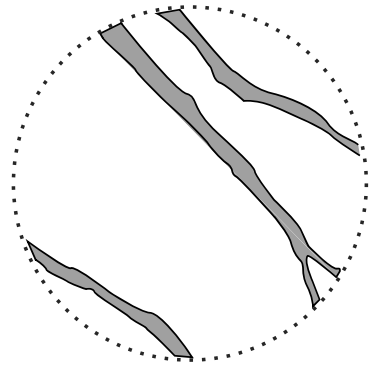

the layout of roots structure defined the shape of proposed construction

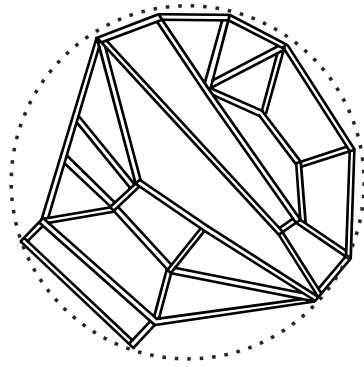

the pattern was created using spruce wood profiles

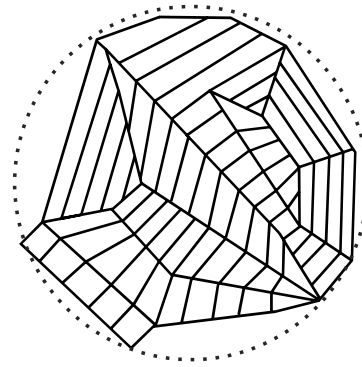

the structure was covered with the Siberian larch decking

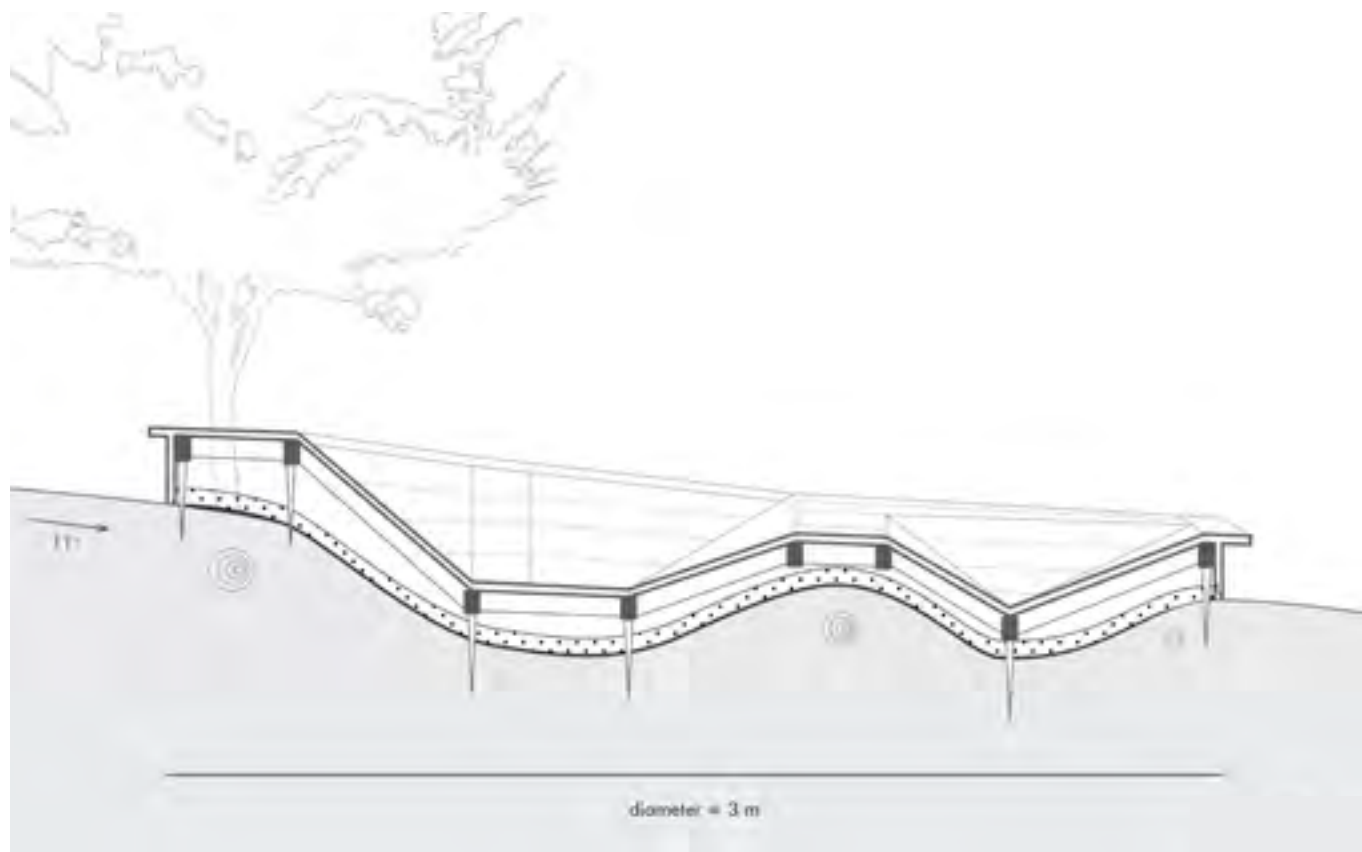

**Designing**  
analyses, section drawing, measurements



**Location**  
visit at the location, meeting with locals



During the first meeting with users on spot group decided to design for the central part of Dendrological Garden. Chosen spot is located near the little wild pond, surrounded by mighty trees which lend a mild and tranquil mood to the place. Nearby trees are framing an astonishing view of the water, the sound of birds allows visitors to draw thoughts away from the busy Niestachowska street, and textures of natural materials allow relief. It was obvious that the main goal for group was to preserve the intimacy of the place.

Led by feelings that they experienced on-site, and amazed by the Garden biodiversity, students decided on construction, which will allow users to focus on nature without significant interference in the landscape.

By using in project natural ground lowering of a diameter of 3 meters authors created structure - the Nest - which protects visitors from the noisy outside world. The shape of the lowering borrows the form of the existing root system as the limit so as not to disturb their growth. An elevated wooden frame is attached to the ground by metal anchors. The frame is site-specific construction fabricated at the spot to mimic the morphology of the existing root network, covered with Siberian larch boards as a finish.

The warped surface of the sunken platform allows every visitor to find a comfortable position no matter what shape type or size his body is. Different levels of terrace engage to focus on tree crowns or water reservoir depending on the user's position. Construction was designed to handle a group of people which make it not only the oasis for contemplating nature but also meeting place for students of nearby University of Life Sciences.



**Project**  
model and realisation comparison

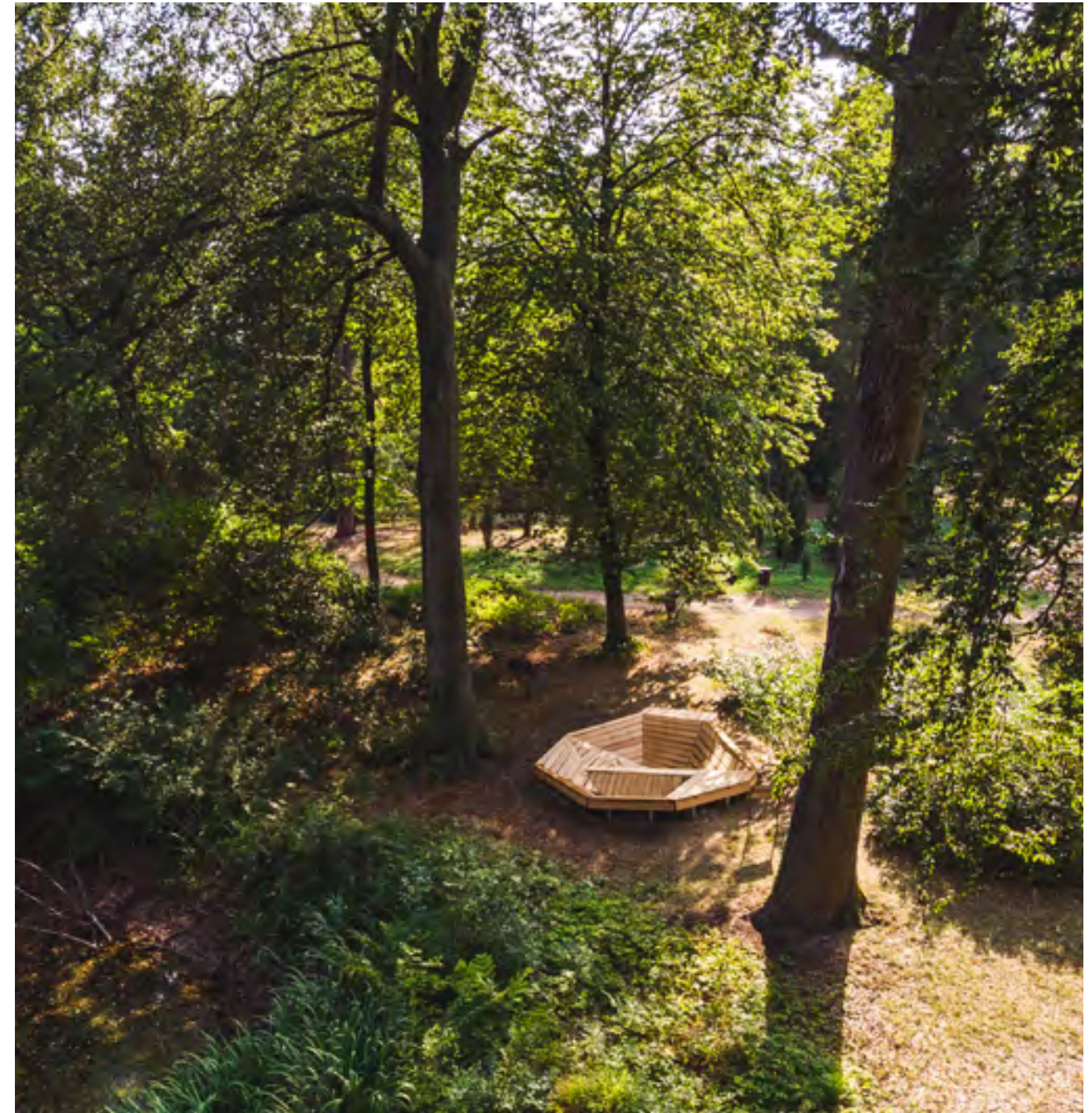





**Constructing**  
working at the location site

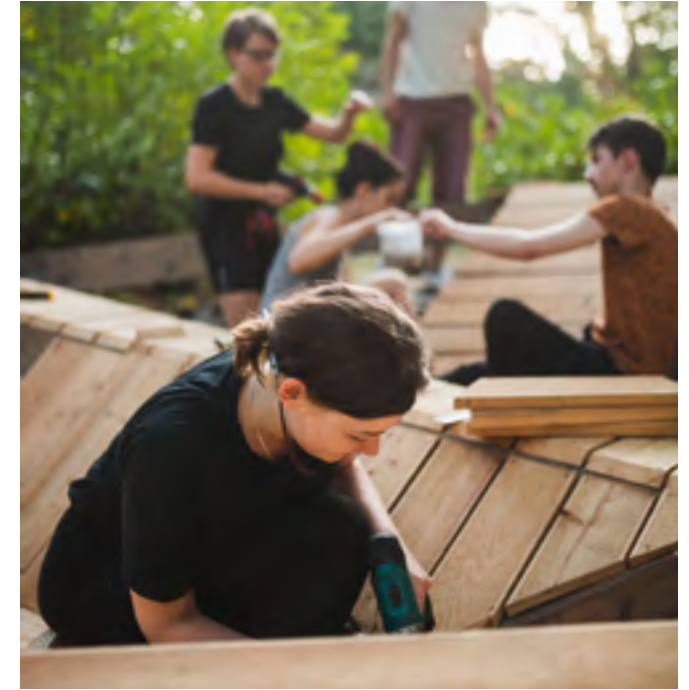



**1. What was the biggest challenge for you during the workshop?**

Constructing our project was by far the most challenging part of the workshop for me. Our 'nest' required us to dig a whole and then from there we basically had to improvise our whole structure step by step with the already ordered wood. If I am going to be honest, I was a bit desperate a few times during the construction but we as a team figured out everything and I think it turned out lovely.

**2. Did your stay in Poland acquaint you with our culture, construction methods and style of architectural design?**

It absolutely did. One of my favourite parts of the workshop was that we spent quite a few nights munching on polish snacks and consuming some nice drinks. And as we did so, we also discussed our similarities and differences about our cultures, schooling systems, styles of architectural designs and so much more. We also gave each other advises about quite a few things, which was really beneficial in my opinion.

**3. Did you learn something new during the workshop, that you will find useful in your studies or future career?**

I got to talk to a lot of people with different experiences and perspectives which opened my eyes to new ideas for the future. The friends I made here also encouraged me not to be afraid of the unusual paths when it comes to architecture and future career which I appreciated so much.

**Viktória Pálffy, Hungary**

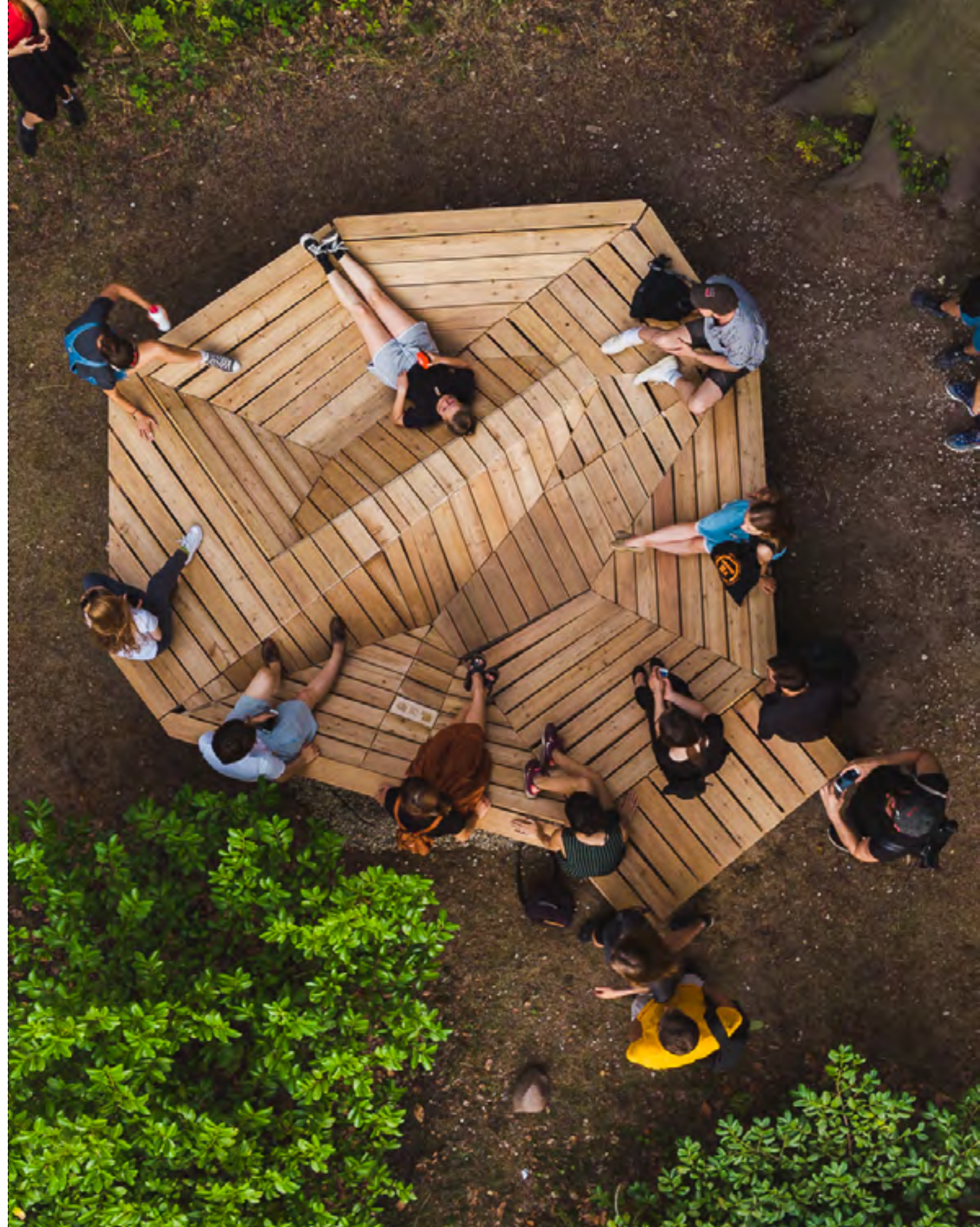





# The Gate Radojewo Park

52°29'53.5"N 16°56'57.1"E

**Tutor:** Studio Nomad - Bence Pasztor + Soma Pongor

**Participants:** Laura Bartha, Matěj Čička, Maria Kwiatkowska, Anna Seimlová, Paweł Skworzec, Jiří Ullwer, Weronika Zaręba, Michaela Vátralová

**Support:** Maria Dondajewska, Ada Kocieniewska, Wojciech Jenerowicz

**Function:** creating a strong visual impression of crossing the border of the forest - providing a place to rest, education about the history and natural resources of the site

**Users:** residents of Radojewo



# Studio Nomad: Bence Pasztor + Soma Pongor

Studio Nomad is a multidisciplinary design studio based in Budapest, Hungary. Bence Pasztor, David Tarcali and Soma Pongor are the founding members with background in architecture. The word 'Nomad' reflects the diversity of our creative work that spans from small objects to larger landscape architectural projects and spatial installations. Our aim is to show the beauty and joy residing in the simplicity of structure and materials. What drives us is our curiosity to experiment and our intention to create something new and unseen.



## 1. What was the biggest challenge in designing for your location?

The biggest challenge was to deal with the rigidity of the Conservatory in such a short time.

## 2. Do you think that these type of workshops (design and construction) bring new value to the educational system for architecture students in your country?

I think these intense design and build workshops are really good for education and can make really deep impressions in all of the participants.



## Student participants:

Laura Bartha  
Matěj Čička  
Maria Kwiatkowska  
Anna Seimlová  
Paweł Skworzec  
Jiří Ullwer  
Weronika Zaręba  
Michaela Vátralová

## Support:

Maria Dondajewska  
Ada Kocieniewska  
Wojciech Jenerowicz



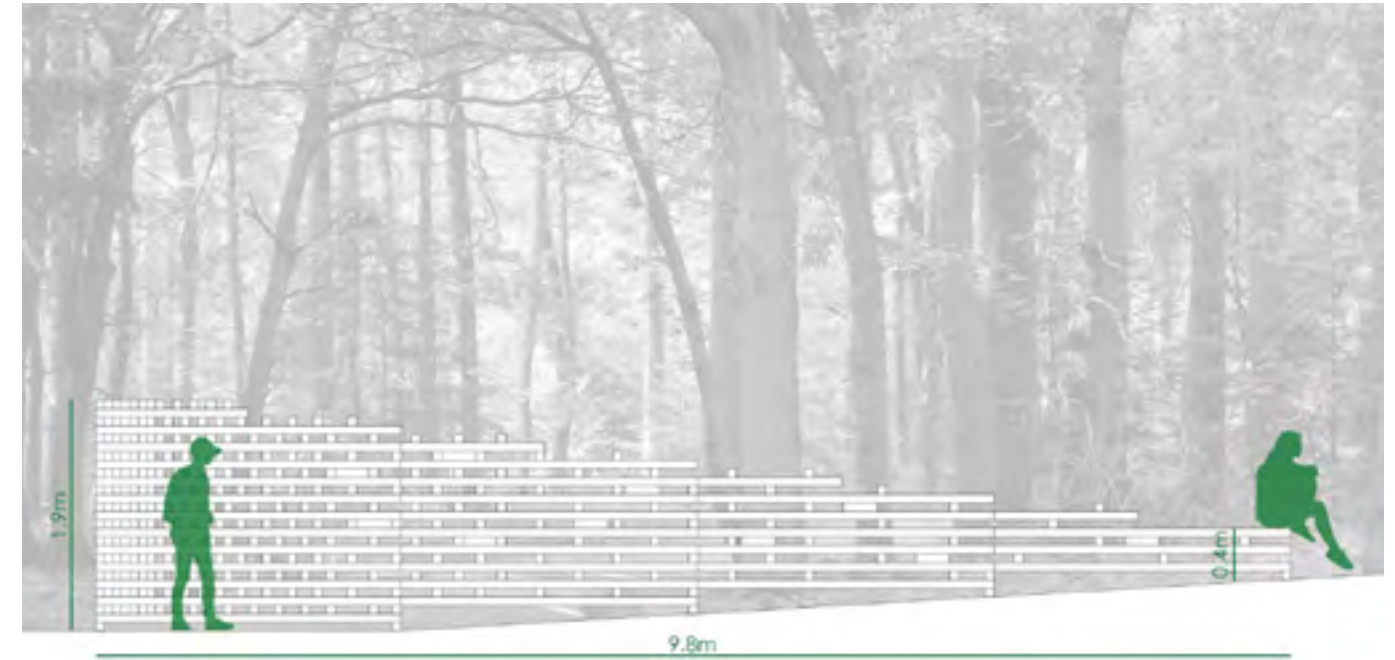

**Designing**  
visit at the location, meeting with locals, drawing and model making





**Project**  
model and realisation comparison



The Gate - installation has three functions: provides a place to rest, creates a strong visual impression of crossing the border of the forest, educates about the history and natural resources of the site.

The horizontal form along with the linden tree growing on the opposite side of the path create a symbolic gate to the forest. It catches the attention, intrigues and encourages to cross the border. The deeper the structure goes into the forest, the more open and looser it becomes. The gradual lowering of the installation creates a sitting

place at the end, moreover the disappearance of the structure symbolizes fading of the traces of the human presence inside the forest.

Educational content of the project is intended to be interactive. It refers to the history of Radojewo village, the palace of von Treskov family and the forest (including local legend). Additionally, the basic knowledge about natural heritage is being presented. All this information is hidden in the structure of the installation.





**Constructing**  
working at the location site





**1. What was the biggest challenge for you during the workshop?**

I think team work, I mean its organization. When to think broadly and invent, when to decide and how. How to summarize and close these stages off. How to share tasks, when to meet with the whole group. What is the role of a tutor in all this? How to speak and present so that everyone understands the same thing.

**2. Did you learn something new during the workshop, that you will find useful in your studies or future career?**

I will repeat what I wrote in the first point - I tried to learn how to organize team work, because it is not as easy as it seems. During the workshop you also learn how to present and communicate your ideas in order to explain what's on your mind in a best possible way. From gestures, through sketches, to quickly created models - it is nice to look at this kind of design communication between people.

**Maria Kwiatkowska, Poland**







# The “Rataje Newts” Ecological Site

52°23'31.1"N 16°58'32.7"E

**Tutor:** Hiroshi Kato + Pola Koch

**Participants:** Michał Wachura, Damian Laskowski, Zuzanna Spaltabaka, Karolina Rossa, Lucie Zádřapová, Kryštof David, Dominika Barlová, Filip Mozdík

**Support:** Marta Adamczak, Marcelina Jankowska, Piotr Górski

**Function:** education, research

**Users:** residents fo Rataje, Traszka Group participants



# Hiroshi Kato

Japanese architect implementing projects in Japan and Europe. His interests include both architecture, design and art. He gained professional experience in Sou Fujimoto studio – as the leading architect and in the Copenhagen COBE studio. In 2011, together with Victoria Diemer Bennetzen, he founded the KATO X Victoria studio, which quickly became one of the best young European architectural studios. The architect also devotes himself to educational and academic activities – organising lectures and workshops for students.



# Pola Koch

Pola Koch - German architect, graduate of TUB Berlin and AARCH in Aarhus. She gained professional experience working in recognised Danish architectural studios such as: JAJA Architects, WE Architecture and EFFEKT Architects.

## 1. What was the biggest challenge in designing for your location?

The site is located in a large park area with a diverse usergroup (including fauna), exposed to potential vandalism. From a practical point of view construction required extra organisation due to no power supply on site.

## 2. Do you think that these type of workshops (design and construction) bring new value to the educational system for architecture students in your country?

For sure these type of workshops bring great value to the educational system as students learn to design and execute a project from A-Z. Communication with clients, budget and time management as well as construction itself is often underestimated during architecture studies.



### Student participants:

Michał Wachura  
Damian Laskowski  
Zuzanna Spaltabaka  
Karolina Rossa  
Lucie Zádrapová  
Kryštof David  
Dominika Barlová  
Filip Mozdík

### Support:

Marta Adamczak  
Marcelina Jankowska  
Piotr Górski



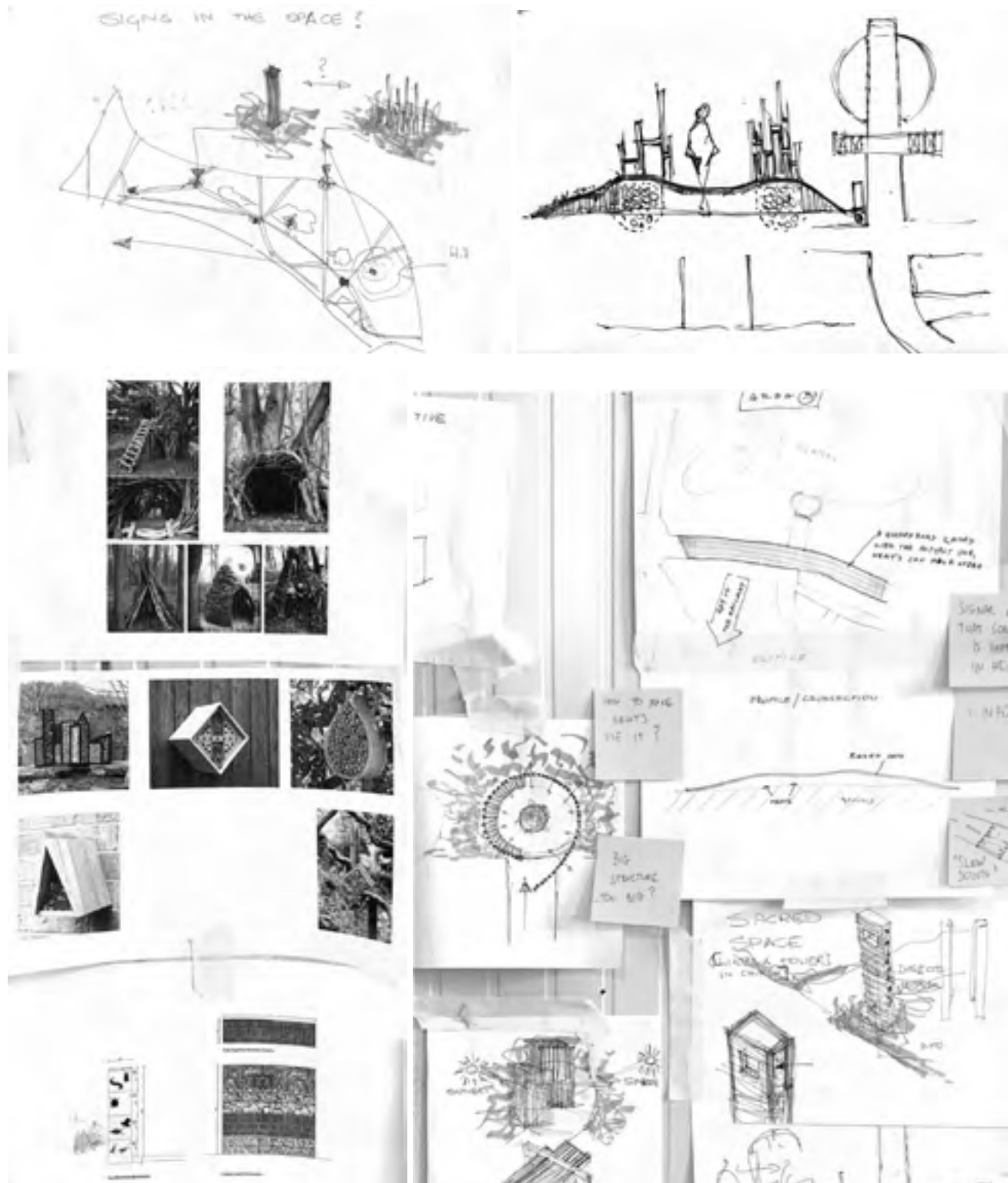

**Designing**  
brainstorming, sketching and model making



**Location**  
meeting with locals and project presentation



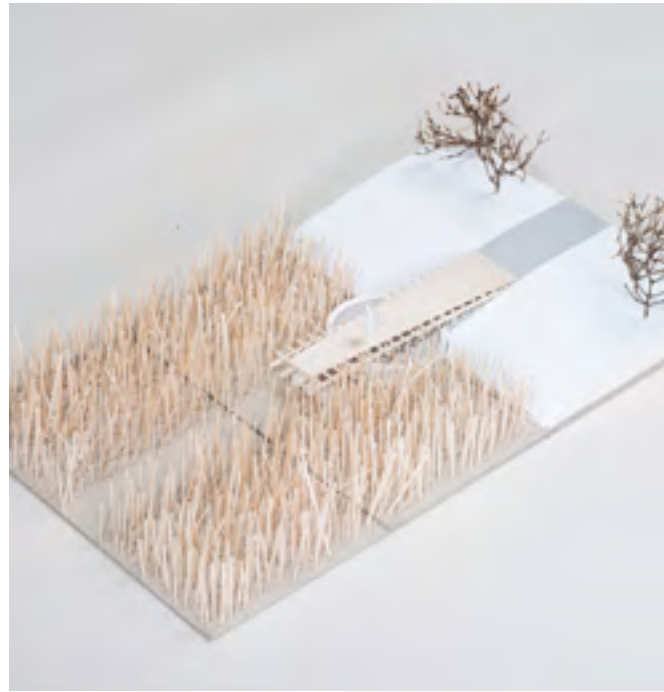

**Project**  
model and realisation comparison



Group proposition was to create the extension of the area that might be used by people as the place to educate – students design the pier which is more accessible for users and at the same time is a perfect place for the native species. To complete project, students used the reeds that was cut down from the axis created between two important anchor points – the concrete platform and the slope on the opposite site of the pond. That way authors created a more appealing space for humans and also a better habitat for newts, other

amphibians and insects. What is more, the educational aim is provided by wooden columns that contain information about newts and their evolution as their presence is not commonly recognized by local people. In order to make it more attractive for children, the tops of all columns are rotating – on one side there is always a question about the size of a newt in a different stage of life and on the other side is a symbolical answer. Columns differ in height to represent the change in size of newts at different stages of their lifecycle.





**Constructing**  
working at the location site

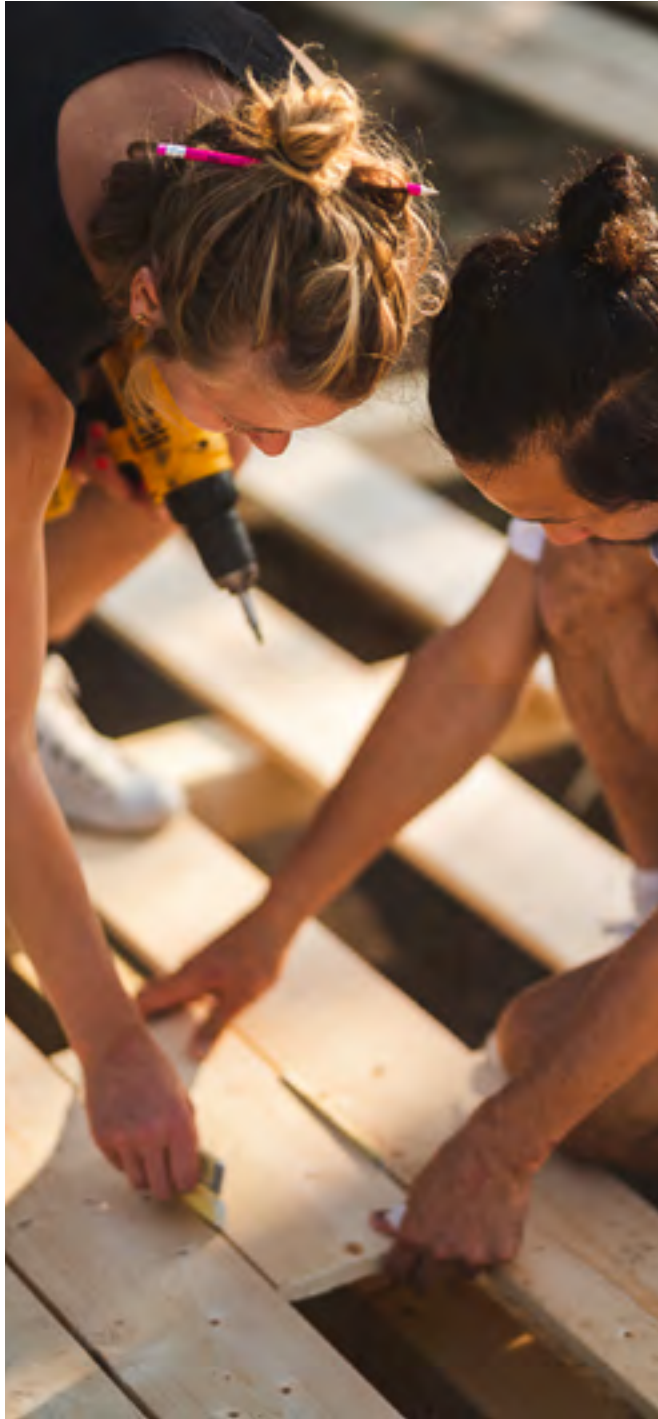



**1. What was the biggest challenge for you during the workshop?**

As every year, the biggest challenge for me was working in a team, especially since the Mood for Wood teams are not just any teams - they are composed of enthusiasts of architecture and design, prepared for intensive work to achieve the best result. And although one might think that working in such a group is a guarantee of an easy success, it is unfortunately not that simple - under the pressure of time the ambitions of the group members clash, and the process of getting to know each other and learning to tolerate each other's presence takes on an express route. Normal work habits do not apply to such intensive workshops, which allows us to learn how to navigate through a new situation, which with a high degree of probability will be useful in further professional life (and outside of it too). During my third participation in m4w it was easier for me in this respect - which show that this method works!

**2. Did you learn something new during the workshop, that you will find useful in your studies or future career?**

Carpentry skills cannot be overestimated - it is not easy to learn to work with wood without access to a well-equipped carpentry shop and teachers such as Szymon. But even more important are soft skills underestimated by formal education - the ability to work in a group, solve problems, act under pressure, find yourself in a new environment and among new people. Because for students of design degrees, the ability to get (and productively so!) through over a week of intense mental and physical work is nothing new.

**Zuzanna Spaltabaka, Poland**







The Mood of Wood workshops are a great challenge for all participants, nevertheless, they always leave satisfaction from the independently created change - a piece of a better space.

It was a unique edition for us - we say goodbye to Poznań and our coordinators - Inga Rolek and Marta Adamczak - thank you for all the work. Big challenges await us - stay with us!

**We would like to thank all the people involved in our project - thanks to you all of this is possible!**



<b>Main Organizer</b>	<b>Polish Association of Architecture in Poznan</b> <b>Association Kolektyw 1a</b> <b>Punkt Wspólny</b>	<b>Partners</b> Visegrad Fund City of Poznań Centrum Inicjatyw Lokalnych Wielkopolska Okręgowa Izba Architektów RP Lasy Państwowe Leniar Marshall Office of Wielkopolska Region Lasy Poznańskie Grupa Traszka Ogród Dendrologiczny School of Form Studio Nomad Brno University of Technology. Architecture Department LOWE
<b>Coordination</b>	Magdalena Wypusz (SARP, Kolektyw 1a) Marta Adamczak (Kolektyw 1a) Inga Rolek (Politechnika Poznańska)	
<b>Site leaders</b>	Magdalena Wypusz Marta Adamczak Inga Rolek Maria Dondajewska Paweł Grabowski	
<b>Visual identity</b>	Marcin Gruchociak	
<b>Photographs</b>	Dawid Majewski	<b>Media</b> ARCH Architektura Murator Architeura i Biznes bryla.pl, infoarchitekta.pl, WhiteMad Magazine, <a href="http://epiteszforum.hu/">http://epiteszforum.hu/</a> , OCTOGON MAgazine, archinfo.sk, archiweb.cz,
<b>Translations</b>	Kosma Lechowicz	

#### Organizers:



#### Partners:



#### Media:





